

## sc. 1:50

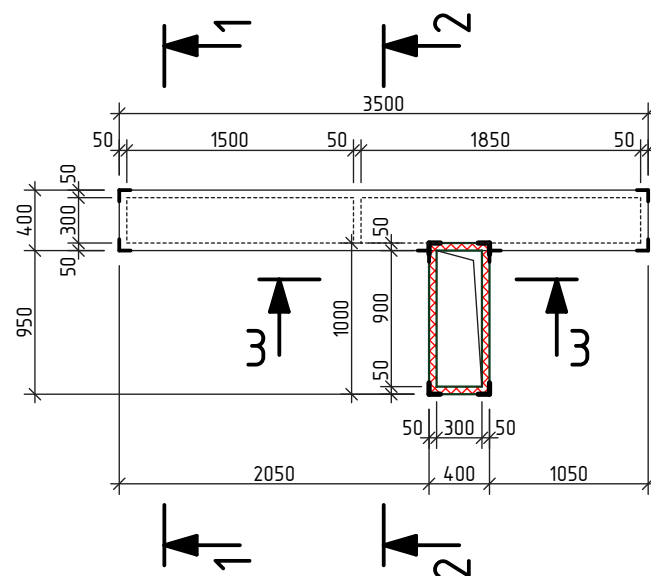

1-1

sc. 1:50

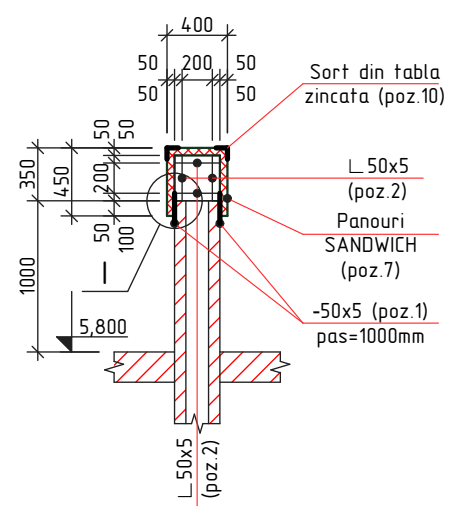

2-2

sc. 1:50

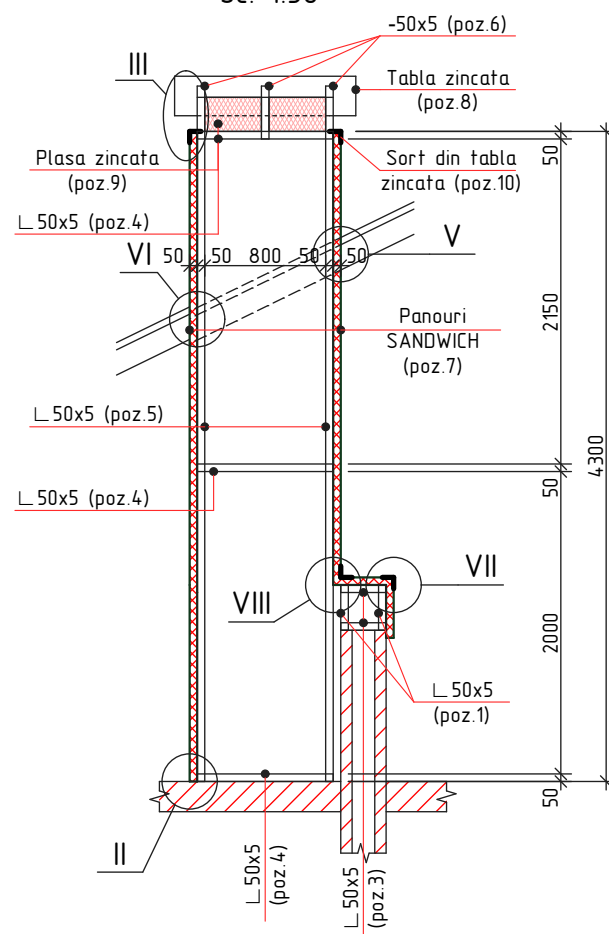

3-3

sc. 1:50

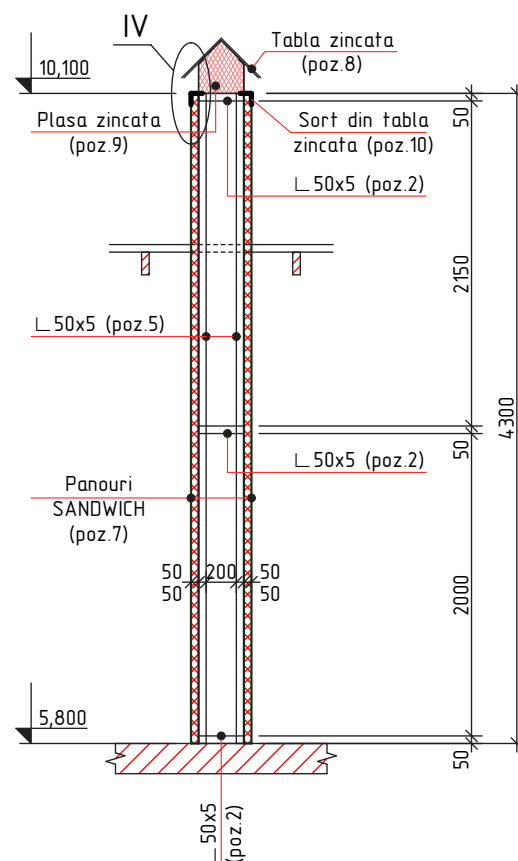

Pozitia	Denumirea	buc.	Massa un. kg.	Nota
	Cos de ventilare Cv-15	1		
1	—50x5 GOST 103-76, l=200	6	0,39	2,34 kg
2	└ 50x5 GOST 8509-86, l=300	18	1,13	20,34 kg
3	└ 50x5 GOST 8509-86, l=3400	4	12,82	51,28 kg
4	└ 50x5 GOST 8509-86, l=900	6	3,39	20,34 kg
5	└ 50x5 GOST 8509-86, l=4300	4	16,21	64,84 kg
6	—50x5 GOST 103-76, l=900	3	1,76	5,28 kg
7	Panouri SANDWICH antifoc de culoare alba, δ=50mm	-	-	15,96 m <sup>2</sup>
8	Tabla zincata de culoare rosie, δ=0,5mm	-	-	0,90 m <sup>2</sup>
9	Plasa expandata zincata, celula 10x20 mm	-	-	0,60 m <sup>2</sup>
10	Sort din tabla zincata de culoare alba δ=0,5mm, L=150mm, l=29400mm	-	-	4,41 m <sup>2</sup>
11	Ancora M6 l=65mm GOST 28778-90	12	0,032	0,38 kg
12	Sort din tabla zincata de culoare rosie δ=0,5mm, L=800mm, l=7000mm	-	-	5,60 m <sup>2</sup>
13	Banda de etansare	-	-	7,00 m
14	Asteriala 500x30(h), S=2,94m <sup>2</sup>	-	-	0,09 m <sup>3</sup>

5. Nodul I,...,VIII vezi pl. 154.

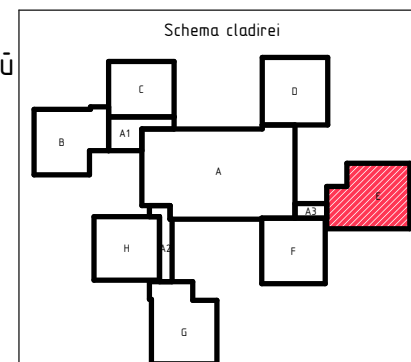

2020	28.07-D/20-SAC			Reparatia capitala a acoperisului scolii primare nr. 21 "S. Vangheli" din str. Tudor Vladimirescu 16				
A.S.P	Mihaila V.		07.20	Scoala primara		faza	plansa	planse
I.S.P	Hihlat Em.		07.20	Bloc E		PE	153	
Elaborat	Mihaila V.		07.20	Cos de ventilare Cv-15. Specificatia materialelor. Sectiunea 1-1,....,3-3		"GEO-CAD-PROIECT" mun. Balti		

Nr.inve.a.orig.	Data si semnatura	Nr.inve.schim.
-----------------	-------------------	----------------